

**AZEK**  
EXTERIORS

# CAPTIVATE®

PREFINISHED SIDING & TRIM



AZEK BEVEL SIDING

FIRST COAT FACTORY-APPLIED | FINAL COAT FIELD-APPLIED





Bevel Siding in Midnight Black

# AVOID MAINTENANCE HEADACHES WITH BEVEL



Bevel Siding in Great Lake

## COLOR YOUR WORLD WITH DURABILITY

AZEK® Bevel Siding is the most authentic-looking replacement for cedar siding on the market today. It offers the premium appearance of natural cedar, but no lifetime of constant painting and waiting for rot. Instead you get the low maintenance of vinyl siding, but with enhanced durability and a high-end appearance. AZEK Bevel is the best of both materials and the lowest maintenance paintable siding on the market today.

AZEK Bevel Prefinished Siding comes from our prefinisher, Russin, with the first coat of paint in your choice of more than a dozen popular colors. When the second coat—same paint and color—is applied in the field after installation, the depth and richness of the color comes through like nothing else. And because there's no wood swelling or movement due to moisture, the paint is going to last.



Moisture Resistant



Rot Resistant



Insect Resistant



Weather Resistant



Durable, Less Long-Term Maintenance



Lightweight



### AZEK® BEVEL SIDING

With rot-proof PVC, there is no paint or stain maintenance schedule, no tannins that stain the surface, and no knots or finger-joints. AZEK Bevel Siding is nearly indistinguishable from wood while eliminating many of the pain points of natural products, and backed by a Lifetime Limited Warranty.



### FIBER CEMENT SIDING

Fiber cement is susceptible to water damage, needs paint for protection, and must be kept off-grade and away from rooflines and masonry contact. It's brittle and requires a silica dust respirator when cutting to avoid inhaling toxic dust.



### NATURAL CEDAR SIDING

Cedar starts out looking beautiful, but can quickly turn into disappointment and callbacks with tannin stains, rotting, splitting, and paint delamination. Cedar guarantees a lifetime sentence of routine maintenance.



### Lifetime Limited Warranty

Captivate substrates carry the AZEK Lifetime Limited Warranty that siding and trim will not experience rotting, splintering, swelling, and warping from excessive moisture absorption. In addition, the paint manufacturer warrants Captivate paint performance for 15 years against cracking, peeling, or flaking.



# EASY TO INSTALL, EASIER TO MAINTAIN

## Installation Benefits

- Installs much like cedar: same tools, face-fastened
- Cut edges do not require sealing, unlike cedar or fiber cement
- Engineered polymer is lightweight and durable
- Uniform finish: no knots or finger-joints
- Flexible, durable material helps prevent onsite breakage

## Low-Maintenance Performance

- No tannin stains or continuous maintenance
- No repainting/restaining cycle like cedar
- Insect-resistant



5.25" x 7/16" (4" Reveal)  
12' Lengths  
25 Boards per square

## INSTALLATION

- A weather-resistive barrier (WRB) must be installed according to the IRC. For best results, AZEK recommends a drainable WRB.
- Install kickout flashing and horizontal flashings per the International Residential Code (IRC). For best results, fasten with hot-dipped galvanized .092" x 2" ring shank siding nail.
- Do not fasten closer than 2" from the end of a plank.
- Where two planks butt together, a joint-flashing is required.

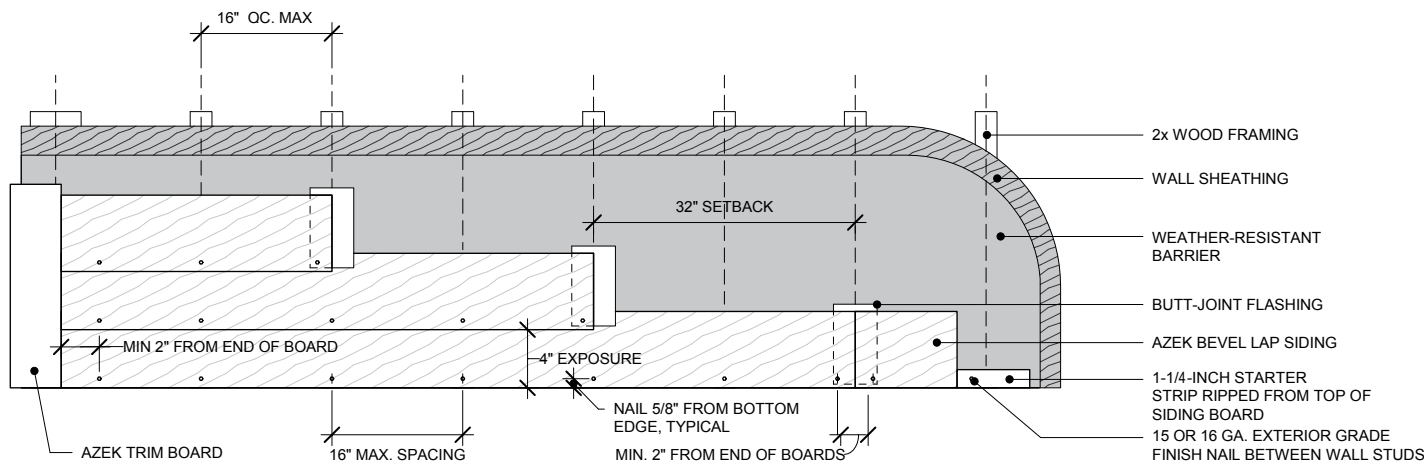

• [https://  
azekexteriors.com/  
captivate](https://azekexteriors.com/captivate)



INSTALLATION  
RESOURCES



A field coat is required over the factory paint coat. Spraying is the preferred painting method.

## FIELD PAINTING REQUIREMENTS

- **Captivate Bevel Siding comes with only one coat of PPG Duracolor paint, additional finish coat must be applied.**
- For in field painted coats only matching paint provided by Russin can be applied.
- For touch ups, only use paint provided by Russin.
- For best results, paint should be sprayed.
- Paint can also be brushed or rolled following industry best practices.
- Follow surface preparation and application procedures recommended by PPG.
- Apply no less than 3 mils of wet film thickness on bevel, final combined dried film thickness must be at least 1.9 mils.
- Apply paint evenly and cover all nail heads.
- Direct any painting questions to your Russin or AZEK representative.



Captivate colors are represented but limited by printing technology—request an actual color sample at Russin.com.



# MORE TIME-SAVING CAPTIVATE EXTERIOR SOLUTIONS

AZEK Exteriors Siding and Trim with PaintPro® Technology is the start of every Captivate prefinished profile listed here.

Choose from a selection of Captivate colors and our prefinisher Russin applies top-quality PPG paint.

Captivate Bevel Siding requires a second field coat.

**All other products are fully prefinished with only field touch-ups required.**

**AZEK**  
EXTERIORS  
**CAPTIVATE**™  
PREFINISHED SIDING & TRIM

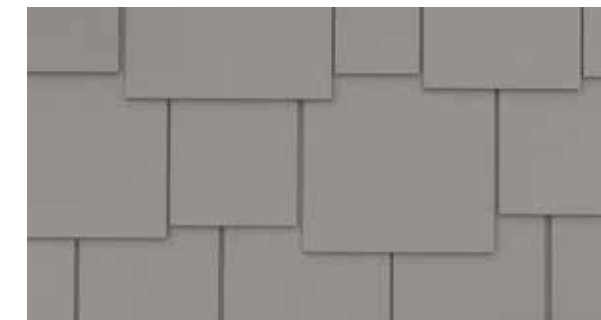

## SHINGLE SIDING

Texture & visual interest

All the timeless beauty of cedar siding without the constant maintenance. Made from a state-of-the-art proprietary engineered polymer for lasting durability. Natural look, amazing performance.



## BOARD AND BATTEN

Flexiblity defines your facade

Free your design from siding constraints. Mix and match different batten strip sizes and vary spacing on the board for a modern yet charming twist to your home's exterior.



## TRIM & SPECIALTY

Great looks & moisture management

Dozens of trim profiles add the details that cap off the entire look. The combination of beauty and durability is best-in-class.

Shingle and Board and Batten Siding in Clambake  
Trim in Cumulus White





**AZEK**  
EXTERIORS

# CAPTIVATE®

PREFINISHED SIDING & TRIM

**AZEK**  
EXTERIORS

[AZEKEXTERIORS.COM](http://AZEKEXTERIORS.COM) | [RUSSIN.COM](http://RUSSIN.COM)

AZEK Captivate is distributed exclusively by Russin®  
Russin, 21 Leonards Dr, Montgomery, NY 12549  
AZEK Exteriors, 1330 West Fulton Street, Suite 350 Chicago, Illinois 60607  
LIT-CAPTIVATE

**RUSSIN**

ESTD 1957